

PowerSet Solo®

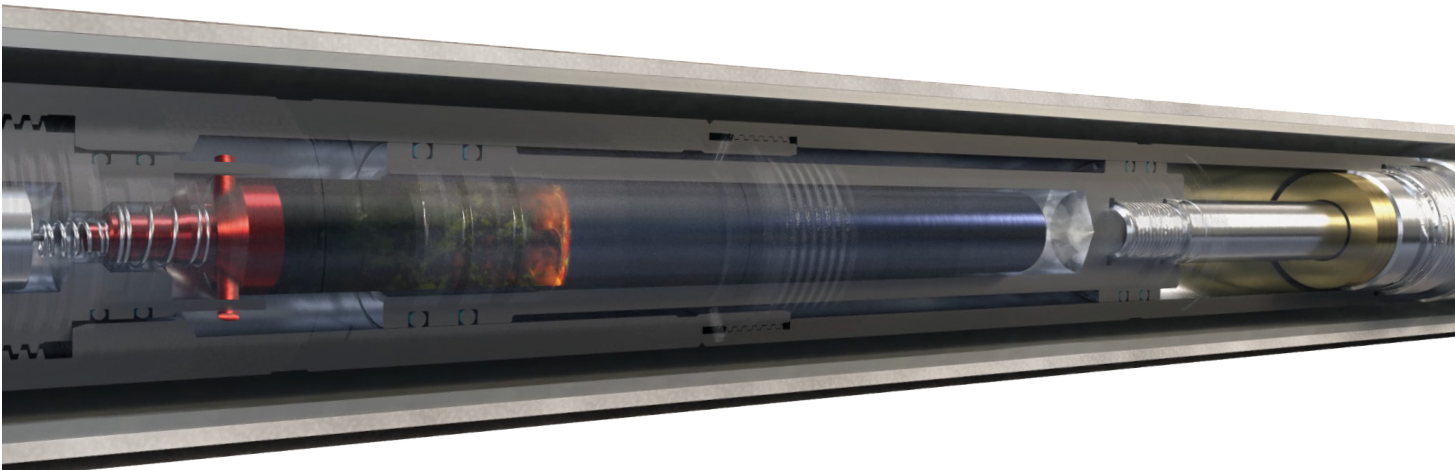

Power charge with built-in initiation device,
Compatible Setting Tools, Hardware

PowerSet® Solo

www.hunting-intl.com/titan

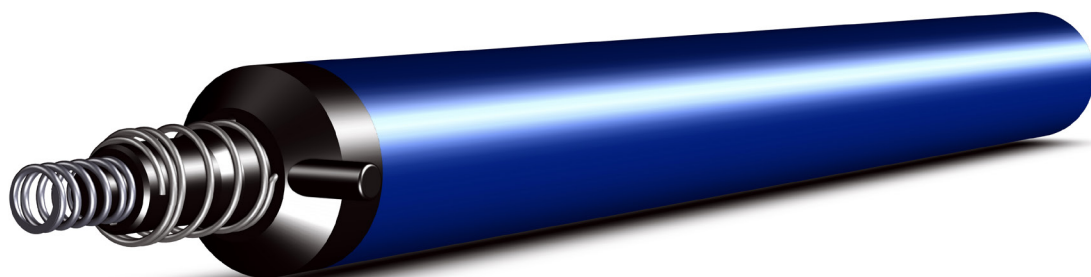

Benefits ▶

- No igniter required
- Optimal, consistent setting times at temperature
- Compatible with existing setting tools
- Plug Shoot Cartridge (PSC) Firing Heads available

PowerSet® Solo is the only power charge with a built in initiation device.

PowerSet Solo Charge Specifications

Specifications	PowerSet Solo #10	PowerSet Solo #20
Part Number	HPC-0010-431	HPC-0020-531
Outside Diameter (in) [mm]	1.31 [33.27]	1.62 [41.15]
Length (in) [mm]	14.85 [377]	14.35 [364]
Max. 1 Hour Temp. Rating (°F) [°C]	350 [177]	350 [177]
Explosive Weight (kg)	0.4 kg	0.5 kg
Hazard Class	1.4C	1.4C
UN Number	0278	0278
DOT Number	EX2016020060	EX2016020060

PowerSet Solo Hardware

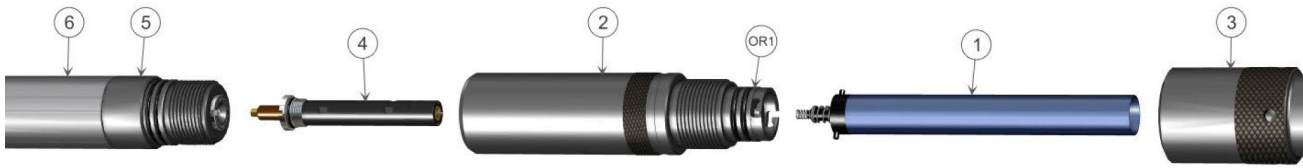

For Use With Plug Shoot Cartridge (PSC) Firing Heads†

ID	Description	Part Number
1	POWERSET SOLO #10 POWER CHARGE	HPC-0010-431
	POWERSET SOLO #20 POWER CHARGE	HPC-0020-531
2	3-1/8" POWERSET SOLO #10 PSC FIRING HEAD	2010-312-200-IPC
	3-1/8" POWERSET SOLO #20 PSC FIRING HEAD	2020-312-200-IPC
3	T-SET® SETTING TOOL	See T-Set Setting Tool Compatibility Table
4	PLUG SHOOT CARTRIDGE (PSC)	HTS-PSC-000
5	3-1/8" ESUB TANDEM ASSY.	0363-ESUB-040B
	3-1/8" EB TANDEM ASSY.	0363-000-389A
6	GUN ASSY; 6 SPF / 60° PHASE	GUN
OR1	O-RING; NITRILE (FOR #10)†	0111-222-090
	O-RING; NITRILE (FOR #20)†	0111-328-090

Note: part numbers displayed are 3-1/8" O.D. for reference. 2-3/4" and 3-3/8" hardware is also available. | †Viton O-Rings required in applications above 325°F. | Firing Heads and O-Rings sold separately.



For Use With PowerSet Recon/Solo Plug Shooting Assemblies

ID	DESCRIPTION	PART NUMBER
1	POWERSET RECON CONTACT ASSEMBLY	2010-APC-010
2	POWERSET RECON PLUG SHOOT BODY	#10 2010-312-501
		#20 2020-312-501
1-2	POWERSET RECON PLUG SHOOT ASSEMBLY	#10 2010-312-500
		#20 2020-312-500
3	POWERSET SOLO POWER CHARGE	#10 HPC-0010-431
		#20 HPC-0020-531
4	T-SET® SETTING TOOL	SEE T-SET COMPATIBILITY TABLE
5	EB TANDEM ASSEMBLY	0363-000-389A
6	GUN ASSEMBLY 6 SPF / 60° PHASE	GUN
OR1	O-RING; NITRILE†	#10 0111-222-090
		#20 0111-328-090

Note: Part numbers displayed are 3-1/8" O.D. for reference. 2-3/4" and 3-3/8" hardware also available. | †Viton O-Rings required in applications above 325°F. | Firing Heads and O-Rings sold separately.

PowerSet® Recon Power Charge

PowerSet® Recon Power Charge Setting Times

POWERSSET SIZE	SETTING FORCE*	75°F [24°C]	180°F [82°C]	250°F [121°C]
#10 Power Charge	25,000 LBS	30 - 50 s	20 - 40 s	10 - 25 s
	35,000 LBS	35 - 55 s	25 - 45 s	10 - 30 s
#20 Power Charge	35,000 LBS	25 - 50 s	15 - 30 s	10 - 20 s
	45,000 LBS	30 - 60 s	15 - 30 s	10 - 20 s
	55,000 LBS	30 - 65 s	15 - 30 s	10 - 20 s

*All PowerSet Recons are rated for use up to 55,000 lbs shear

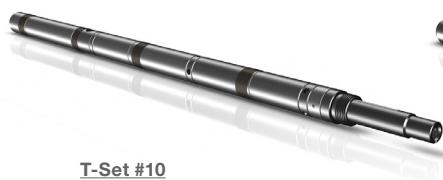

T-Set #10



T-Set #20

T-Set Setting Tool Compatibility with PowerSet® Recon Power Charges

COMPATIBLE T-SET PART NUMBER	POWER CHARGE #10 HPC-0010-431	POWER CHARGE #20 HPC-0020-531
T-Set #10 Setting Tool WST-BK10-001	✓	
T-Set #10 Non-Ported Setting Tool WST-BK10-201	✓	
T-Set #10 High Pressure Setting Tool WST-BK10-002	✓	
T-Set #20 Setting Tool WST-BK20-001		✓
T-Set #20 Non-Ported Setting Tool WST-BK20-201		✓
T-Set #20 High Pressure Setting Tool WST-BK20-002		✓

Further Information

Web

www.hunting-intl.com

Email

sales.titan@hunting-intl.com
support.titan@hunting-intl.com

Global Headquarters

Hunting Energy Services Inc.
 16825 Northchase Drive, Suite 600
 Houston, Texas 77060-3236
 USA



HUNTING

'Excellence in Energy Services for over 100 years'